

LAND OF SRI SOUGATA DUTTA,
SRI RINKU CHAKRABORTY & SRI SUBRATA BHAYAL

LAND OF JANTA BARMAN, ISTA MOHAN BARMAN,
JIBAN BARMAN, PARESH BARMAN & RAJAN BARMAN

FUTURE DEVELOPMENT

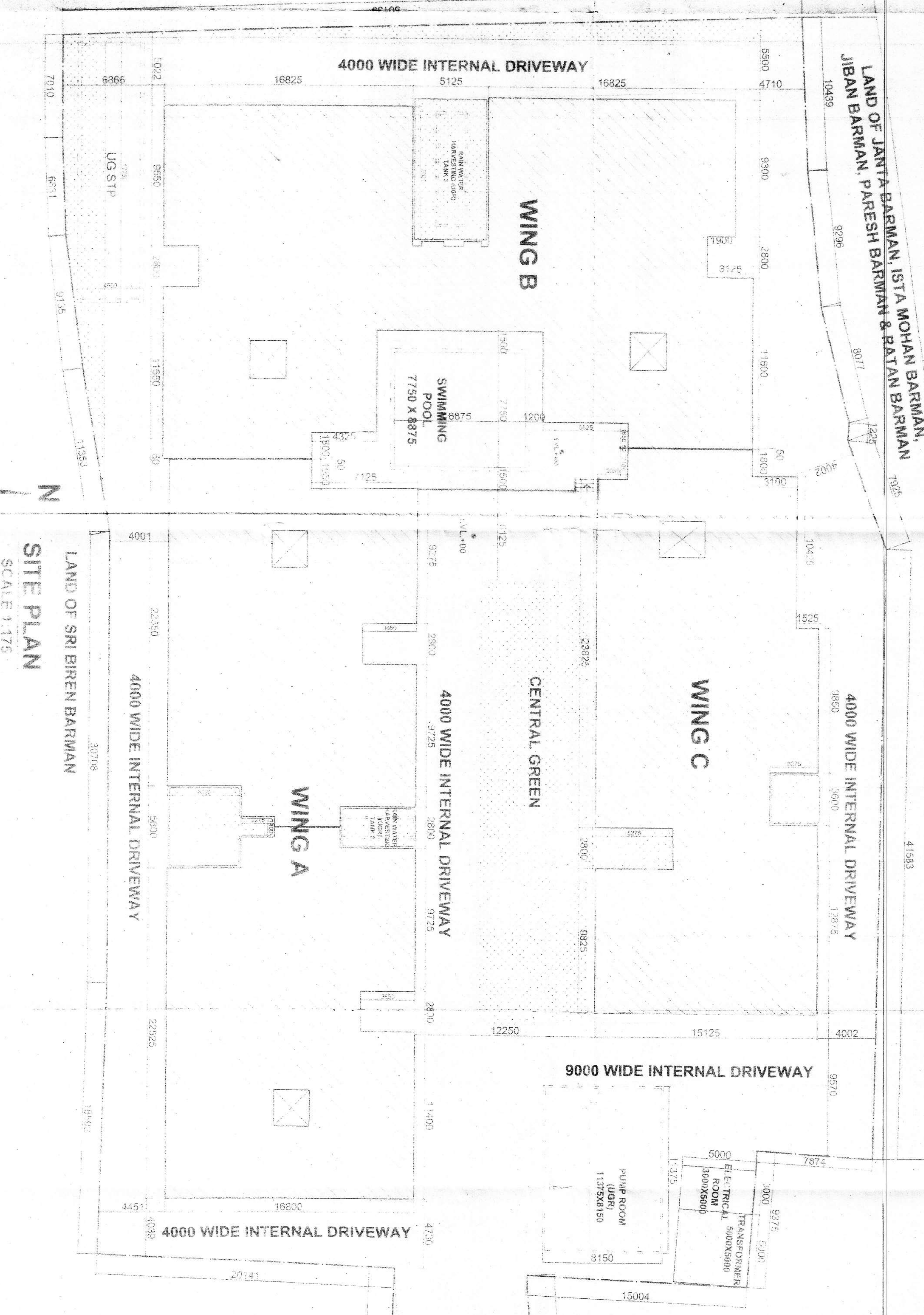

SITE PLAN
SCALE 1:175

SECTION A-A
66 KLD STP
SCALE 1:100

SECTION THROUGH P.P.
SCALE 1:200

PUMP ROOM & UGWF DETAILS
SCALE 1:200

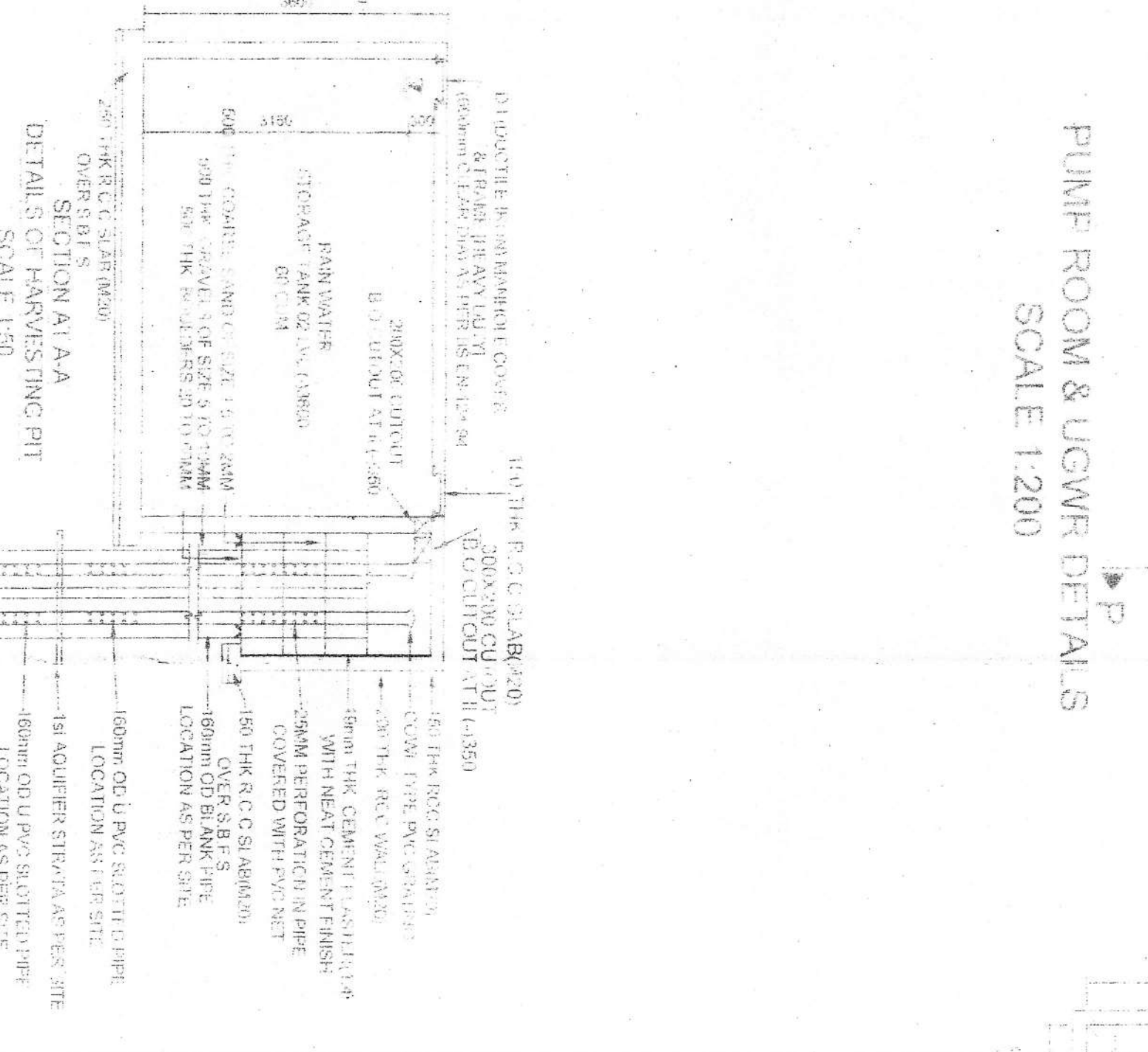
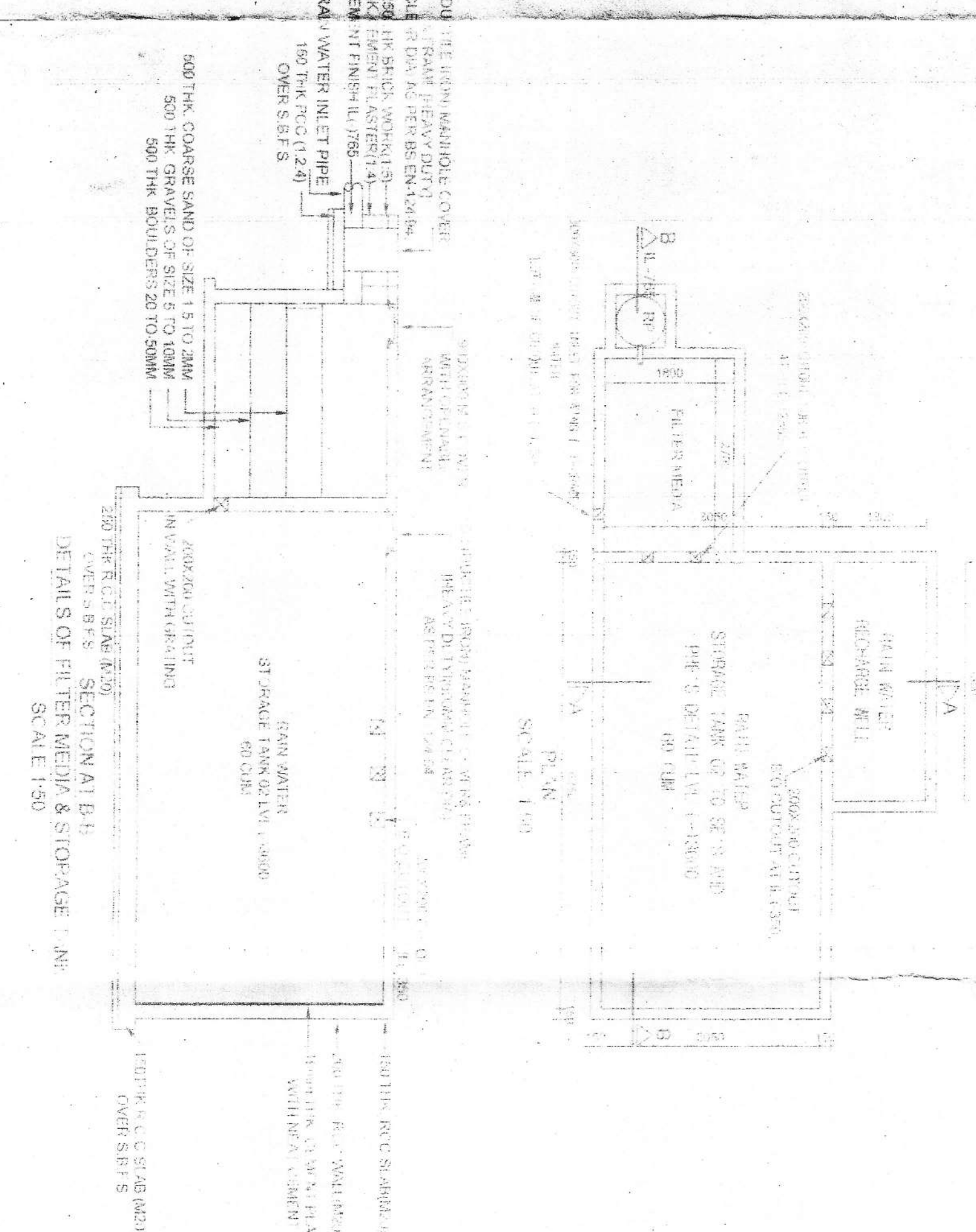
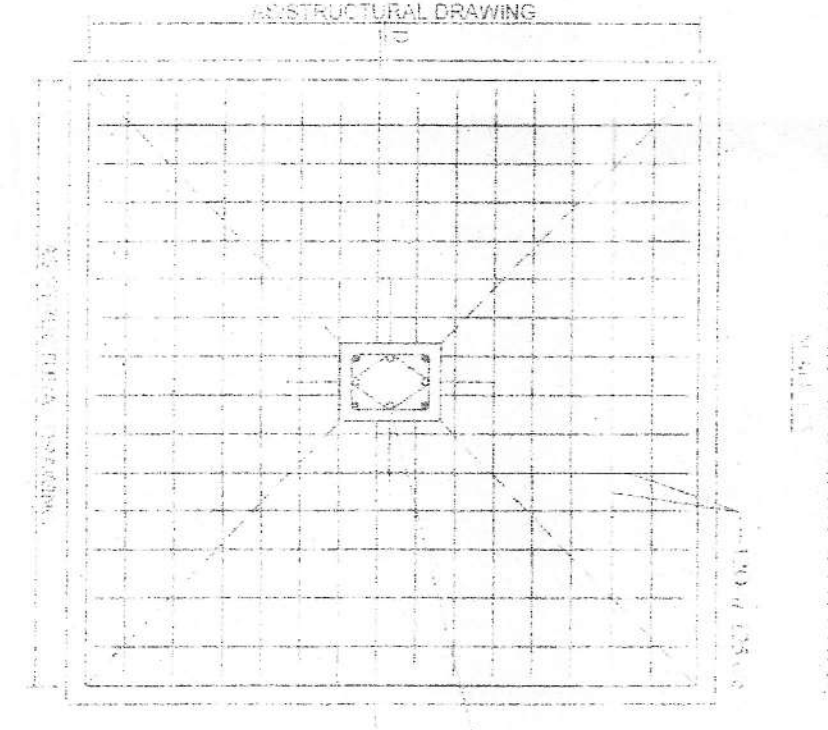

Mr. further vertical
extension will be
granted.

May be Vetted

Additional Executive Officer
User Department
District Engineer
User Department

Approved

MSJH DEVELOPERS LLP

Rajon Koley
Rajon Koley
Sri Ranjan Koley
Rajon Koley

PANKAJ KUMAR
PANKAJ KUMAR